

PRESSURE TEST VALVE Part no. 500670.2



Fine control valve

See operating instructions on the back

Connection 1/8" to apply test pressure

e.g. hose \varnothing 7 mm, pump, etc.

Quick-action coupling DN2.7, self-closing
for connection to installation/process

Hexagon socket screw for fixation/securing
on BlueLine® pressure measuring instruments and CAPBs®

Connection pressure measuring instrument (inner \varnothing 8 mm)



- Especially for pressure measuring instruments of the BlueLine® series S4600 ST/S2600 and CAPBs®.
Fine adjustment valve for precise adjustment (filling, venting, settings, etc.)
- Reduces pressure surges, protects the pressure measuring instrument
- Practical quick-action coupling DN2.7
- Application for pressure measurements with neutral gases
- Maximum pressure P_{max} 20 bar / maximum temperature T_{max} 40 °C

ASSEMBLY TO THE PRESSURE MEASURING INSTRUMENT

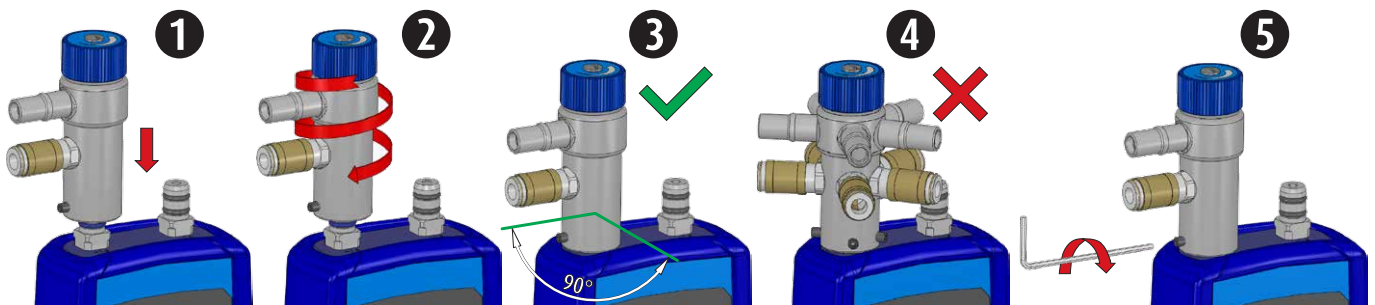

i Safety Instructions: Use only within the specifications - P_{max} 20 bar, T_{max} 40 °C, possible hazard of gases, consider pressure or vacuum, use suitable hoses, secure pressure relief valve on the measuring instrument **5**, if necessary, secure hose connections against loosening.

Conformity: According to pressure equipment directive (2014/68/EU), valves are pressure retaining equipment and may not be marked with CE. Design, manufacturing according to „GIP - of good engineering practice“.

OPERATING INSTRUCTIONS

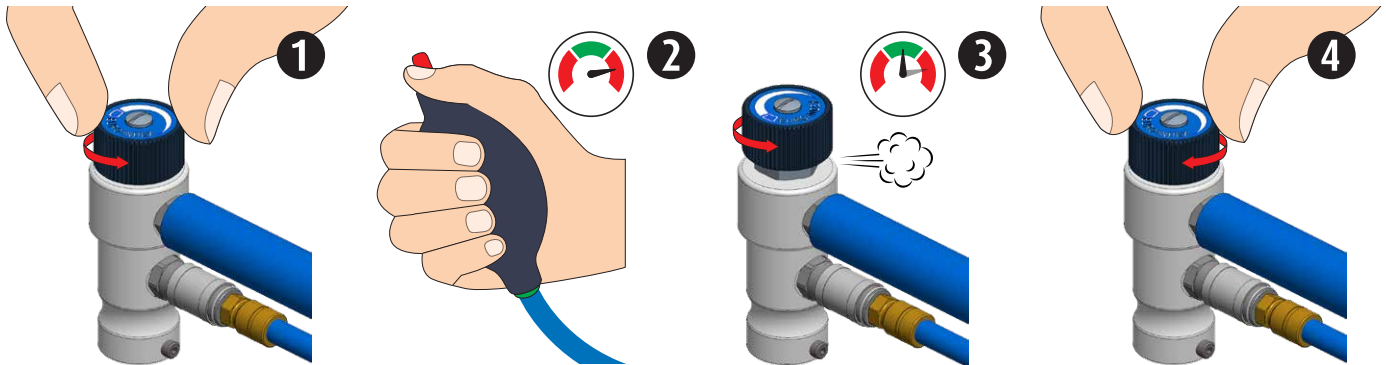

APPLICATION EXAMPLE LEAK TEST

i Note pump direction!

S4600 ST series

Pumpball with connection hose \varnothing 7 mm

Conical test plug with plug-in nipple DN5

Connection hose with plug-in nipple DN2.7 and coupling DN5

Bluetooth®

EuroSoft® connect App

Download on the App Store

GET IT ON Google Play

Available for Windows

connect

CAPBs® device

+

CAPBs® sens

PS20 (150 mbar)
PS33 (2 bar)
PS40 (6 bar)
PS60 (20 bar)

Bluetooth®

EuroSoft® live App

Download on the App Store

GET IT ON Google Play

Available for Windows

live